



22 Hartington Street, Bedford MK41 7RP





22 Hartington Street  
Bedford  
MK41 7RP

Guide £300,000

Victorian terrace house

Living room

Dining room

Modern kitchen

Ground floor bathroom

Three bedrooms

Low-maintenance garden

Gas central heating

Double glazing

No chain

Freehold



- Council Tax Band B
- Energy Efficiency Rating D

A well-established terrace home within walking distance of the town centre...



Set within the popular Prime Ministers' area, this Victorian terrace property is offered with no onward chain.

The ground floor offers a living room to the front of the property, a separate dining room, and a modern kitchen beyond. Towards the rear of the house there is a ground floor bathroom.

On the first floor there are three well-proportioned bedrooms, including a good-sized master. Additional benefits include gas fired central heating and double glazing.

To the rear of the property, there is a low-maintenance garden with artificial lawn.

Local shopping and schooling are both within walking distance, and the property is generally considered to be in an excellent location with its proximity to the town centre and train station, as well as Bedford's sixty-two-acre Victorian park with its café and public tennis courts being within easy reach.

## Hartington Street, Bedford, MK41

Approximate Area = 831 sq ft / 77.1 sq m

For identification only - Not to scale

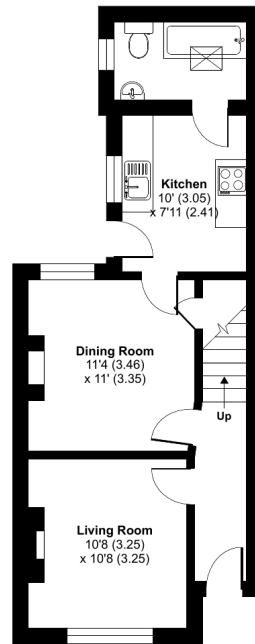

GROUND FLOOR

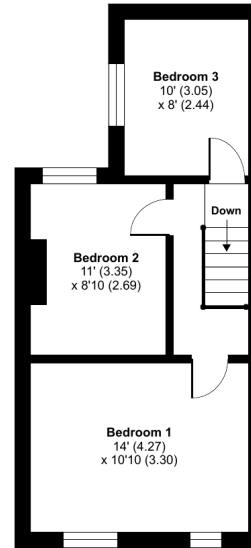

FIRST FLOOR

 Floor plan produced in accordance with RICS Property Measurement 2nd Edition, Incorporating International Property Measurement Standards (IPMS2 Residential). © nrichcom 2026. Produced for Lane & Holmes. REF: 1403341



01234 327744 | [sales@laneandholmes.co.uk](mailto:sales@laneandholmes.co.uk) | [www.laneandholmes.co.uk](http://www.laneandholmes.co.uk) | 66-68 St Loyes Street, Bedford, Bedfordshire, MK40 1EZ

Agents Notes: The agent has not tested any apparatus, equipment, fixtures & fittings or services and so cannot verify that they are in working order or fit for the purpose. A buyer is advised to obtain verification from their solicitor or surveyor. All photographs shown are for illustration only and may depict items that are not for sale or included in the sale of the property. Please note that we have not checked the situation with regards to planning consents, building regulation consents and any other relevant consent relating to this property and therefore, any interested applicant should carry out their own enquiries with the appropriate authorities. All measurements are approximate and for guidance only. The particulars do not form part of any contract and all properties are offered subject to contract.

